

Imagem 1 - perspectiva caixa de areia



Imagem 1 - vista superior caixa de areia



Imagem 2 - perspectiva caixa de areia

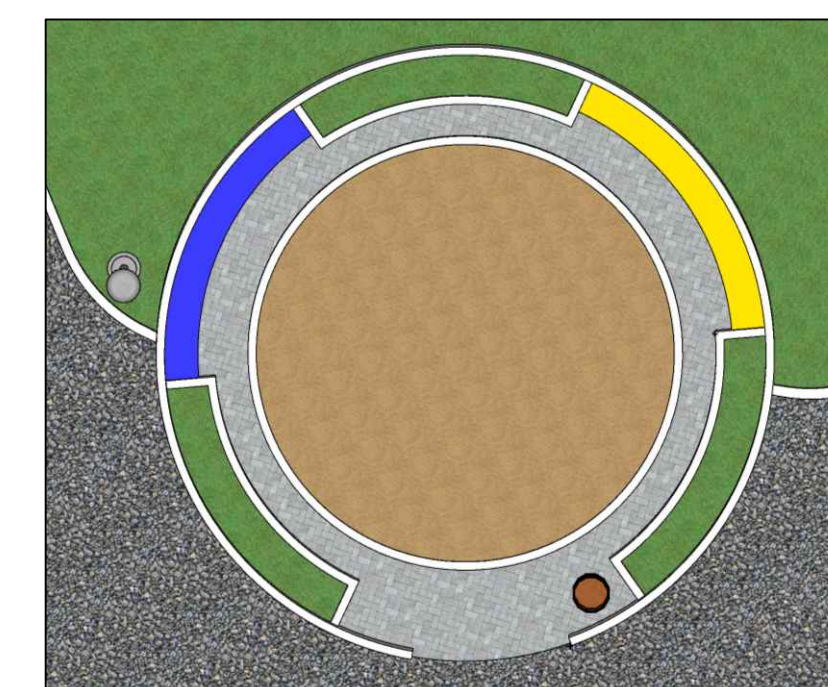
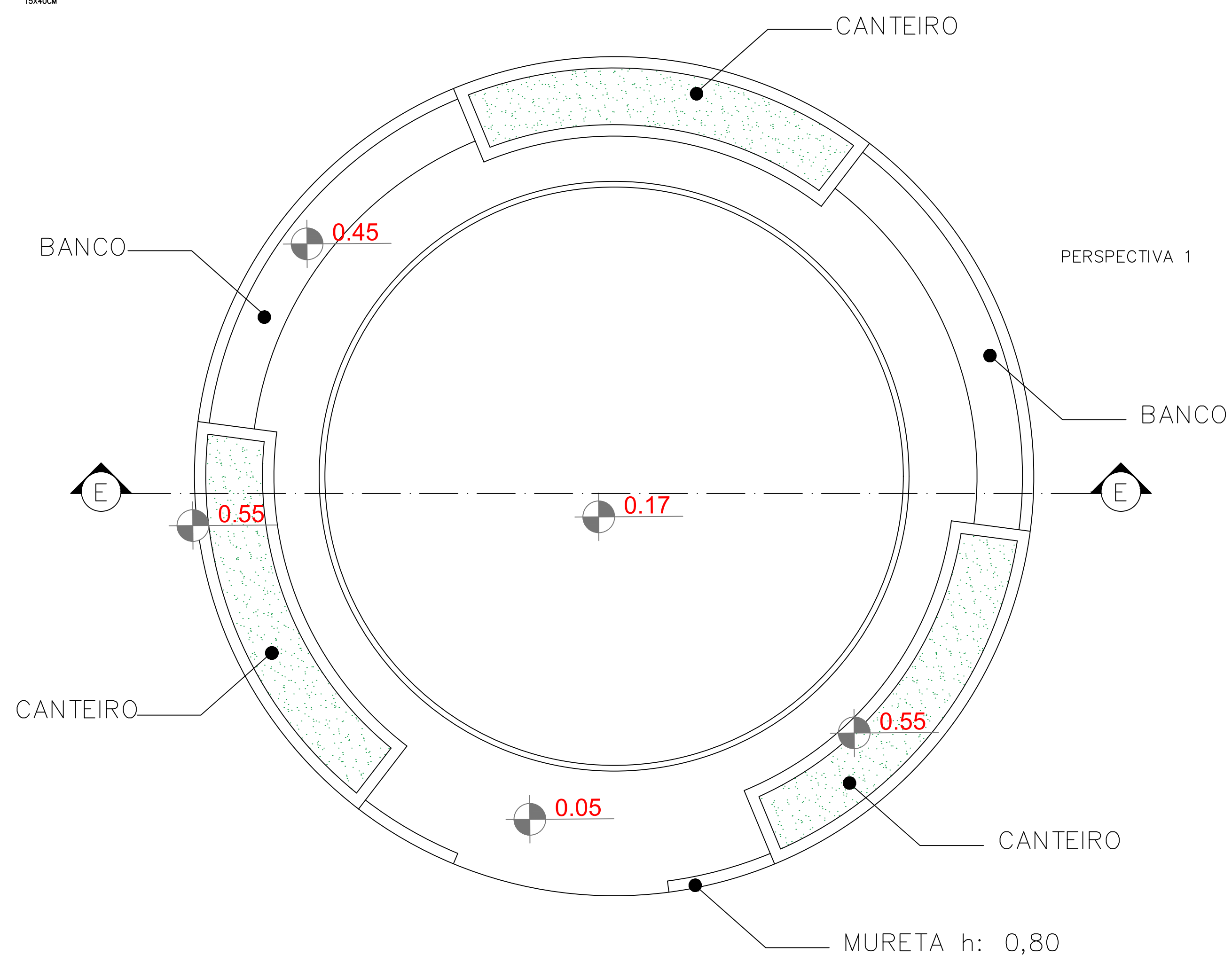
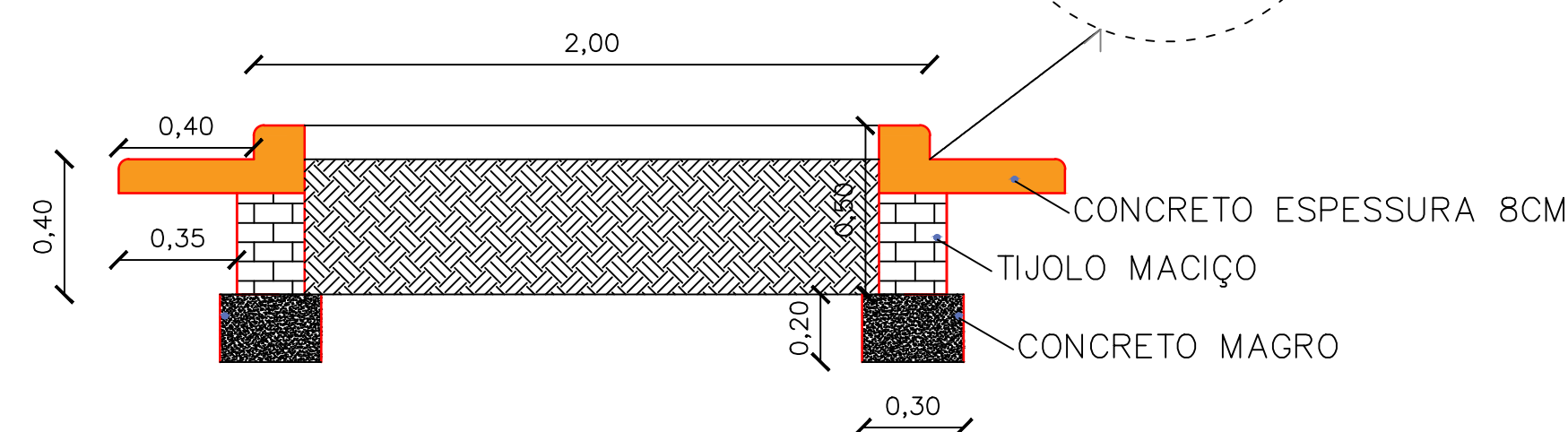
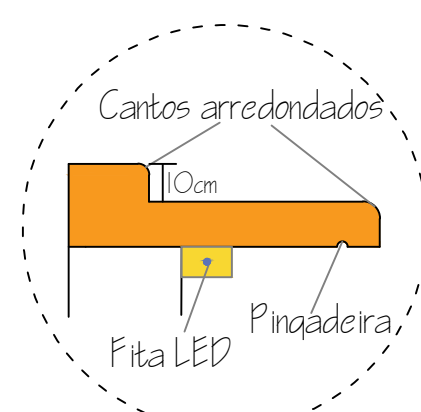

DETALHAMENTO CANTEIROS

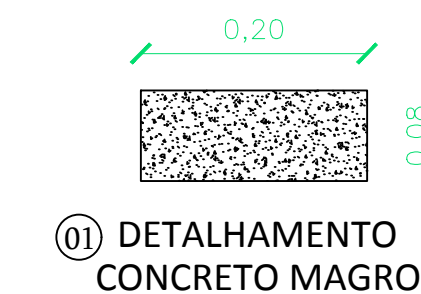
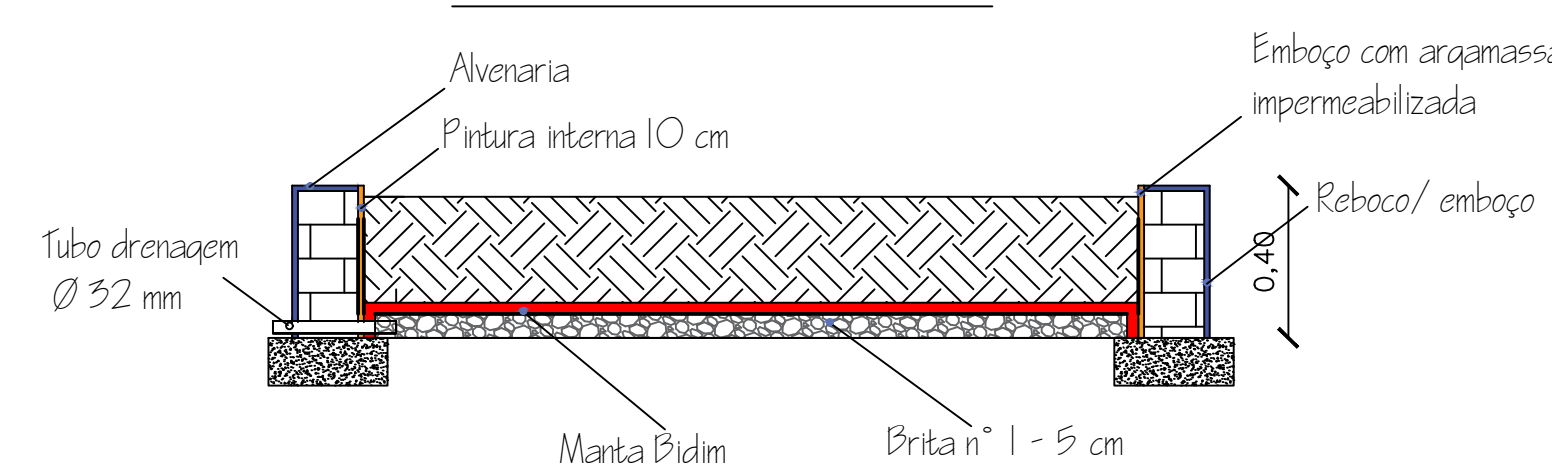

DETALHE DO BLOCO DE CONCRETO, BASE PARA POSTE DE ILUMINAÇÃO ALTURA 2,5 METROS
Dimensão do bloco 0,40x0,40x0,40

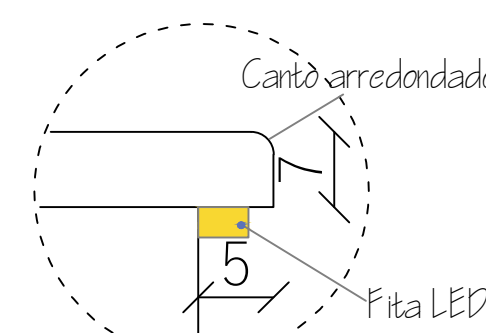
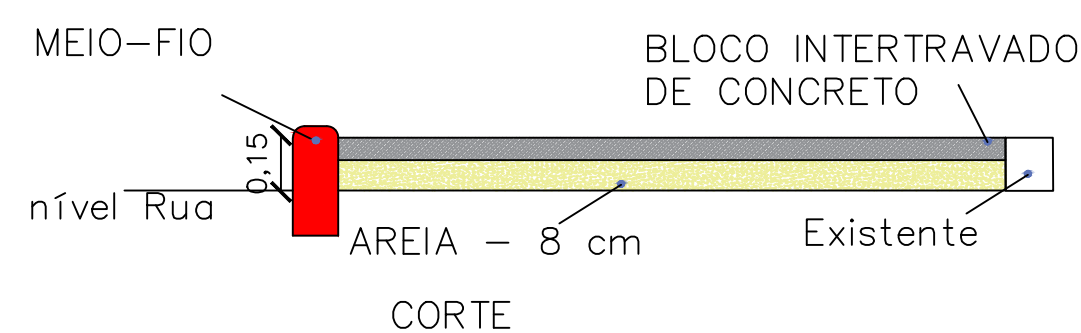
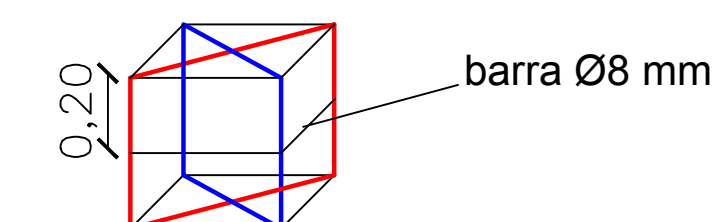

DETALHE DO BLOCO DE CONCRETO, BASE PARA POSTE DE ILUMINAÇÃO ALTURA 10 METROS
Dimensão do bloco 1x1x1

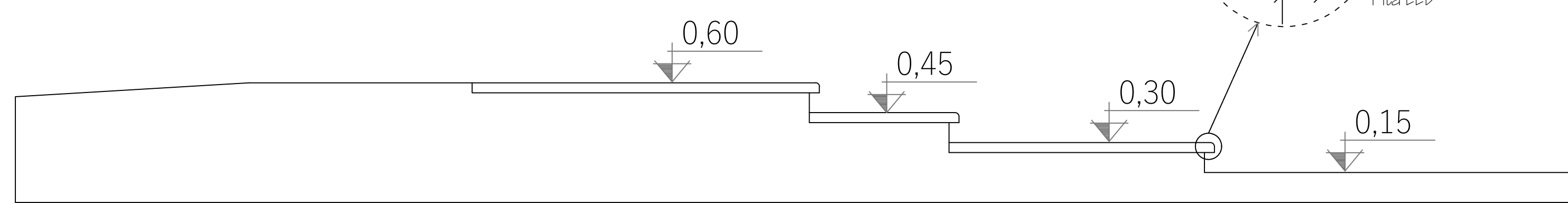
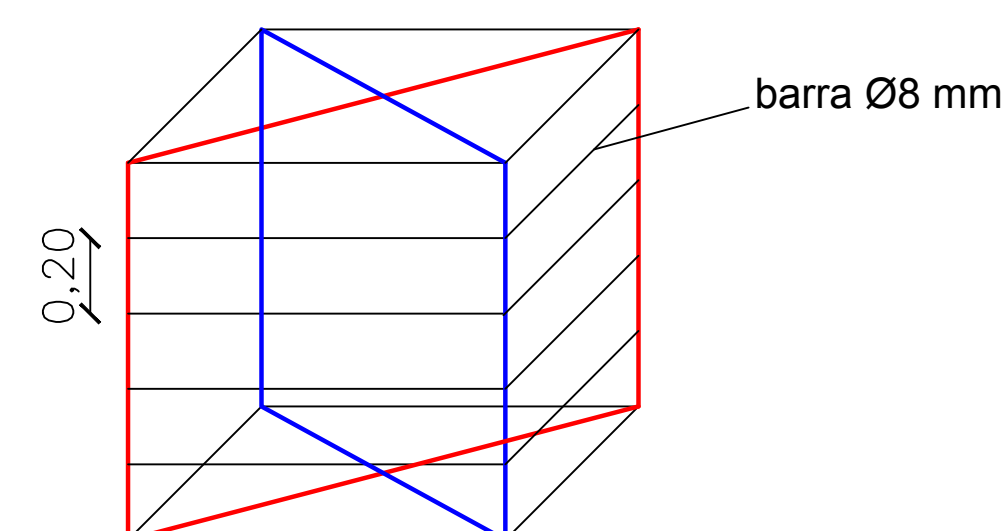

CORTE ESCADA



| | | | |
|---|--|------------------|-------------------------|
| DEPARTAMENTO MUNICIPAL DE ENGENHARIA | | | |
| PREFEITURA MUNICIPAL DE TENENTE PORTELA | | | |
| PROJETO DE REFORMA DA PRAÇA ALIBINO RIGON | | ÁREA CONSTRUÍDA: | 2.567,11 m ² |
| PLANTA BAIXA E PLANTA DE COBERTURA | | DATA: | DEZEMBRO/2019 |
| Colaboração: | | | |
| FERNANDA HERMES SOARES E JACKSON JORGE BITENCORTE | | | |
| Engenheiro Civil | | REGISTRO CREA: | 180283 |
| ELIANDRO TIECKER | | ESCALA: | 1:125 |
| Resp. Técnico | | FRANCHA: | 08/11 |
| Prefeito Municipal | | | |